



A



B



C



Li-ion

D



E



F



G



H

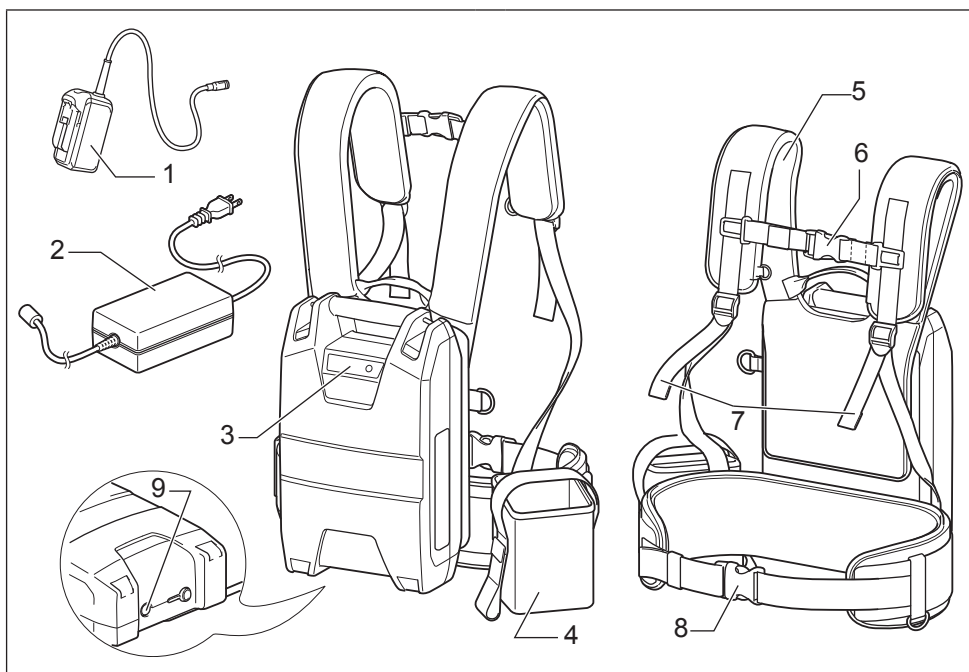

1

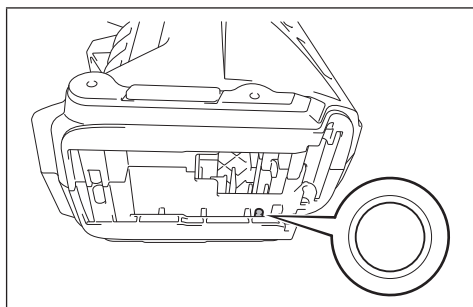

2

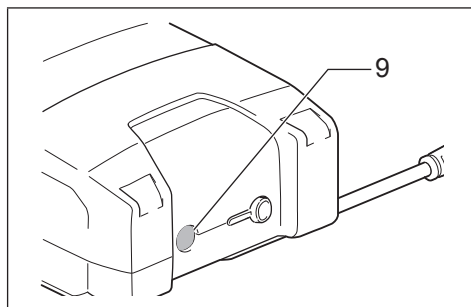

3

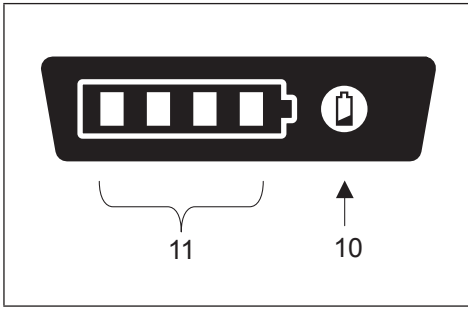

4

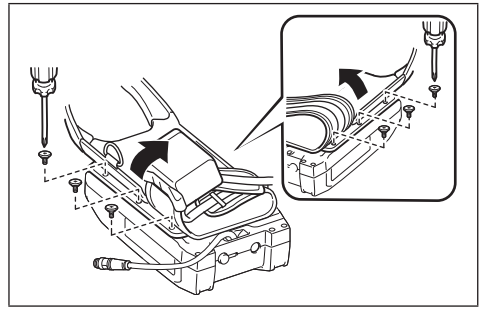

5

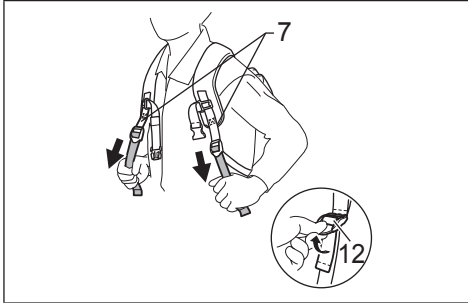

6

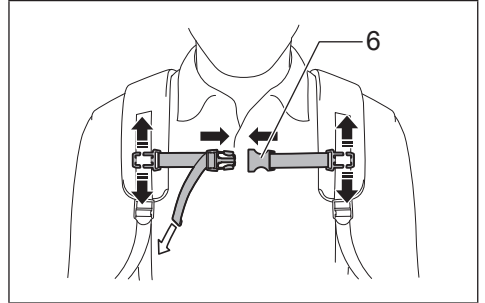

7

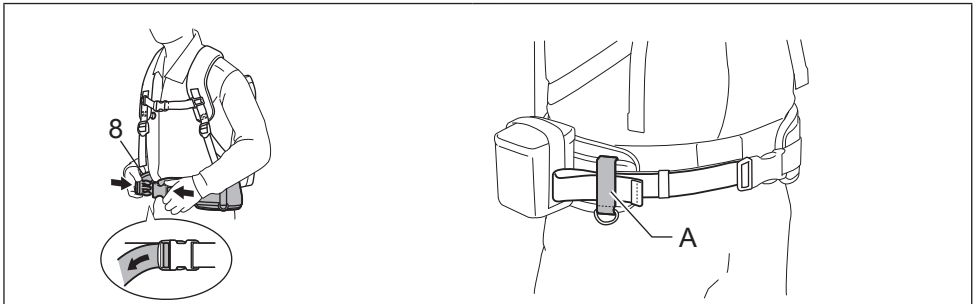

8

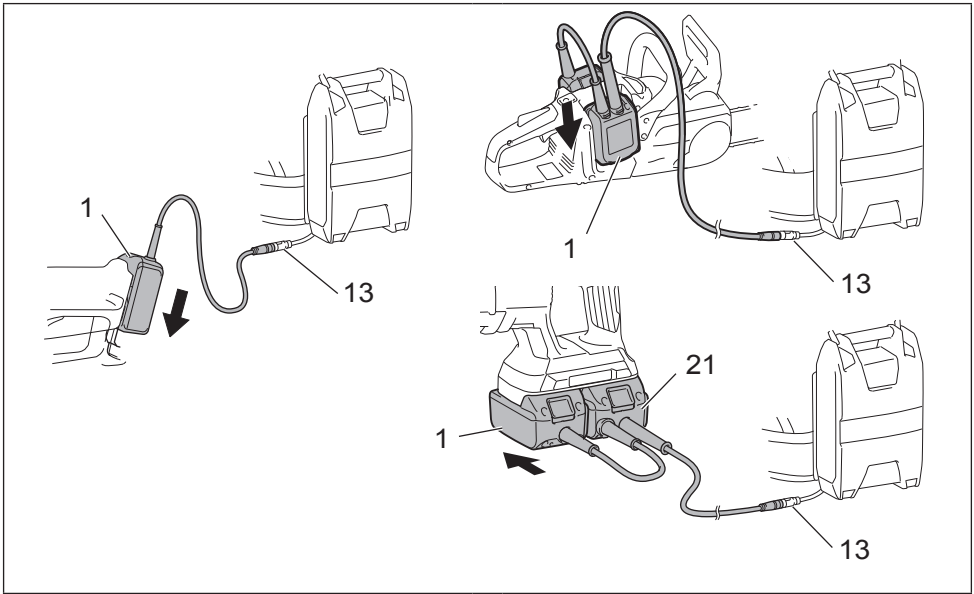

9

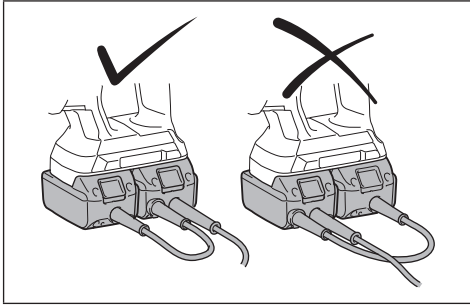

10

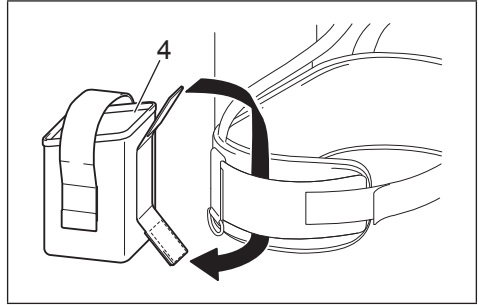

11

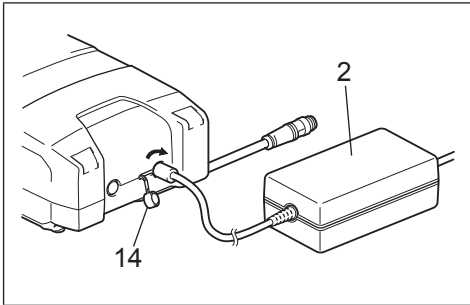

12

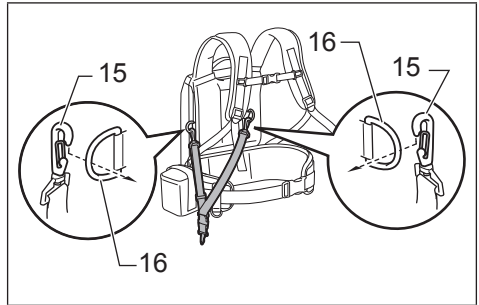

13

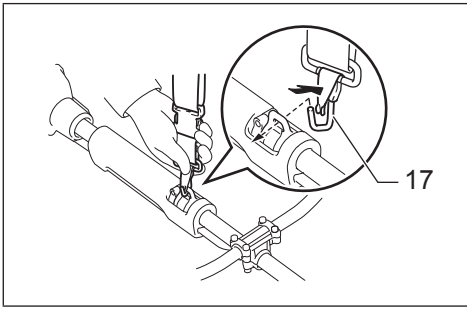

14

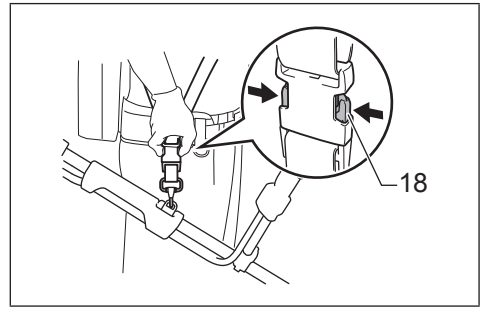

15

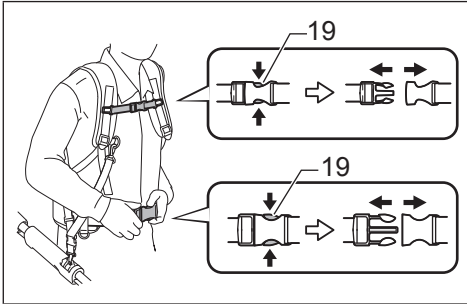

16

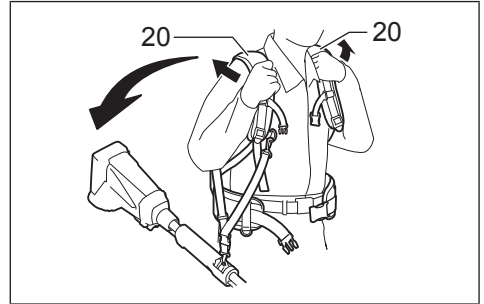

17

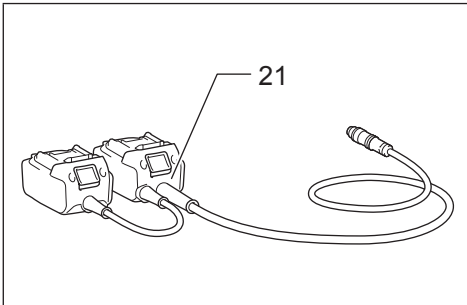

18

ENGLISH

SYMBOLS

- A. Read instruction manual.
- B. DOUBLE INSULATION
- C. Do not short batteries.
- D. Always recycle batteries.
- E. Do not expose battery to water or rain.
- F. Do not destroy battery by fire.
- G. Indoor use only
- H. Only for EU countries
Do not dispose of electric equipment or battery pack together with household waste material!
In observance of the European Directives, on Waste Electric and Electronic Equipment and Batteries and Accumulators and Waste Batteries and Accumulators and their implementation in accordance with national laws, electric equipment and batteries and battery pack(s) that have reached the end of their life must be collected separately and returned to an environmentally compatible recycling facility.

COMPATIBILITY

This battery is intended for use with olive harvester, blower, hedge trimmer, chain saw, hammer, and light.
Do not use this battery with circular saw, miter saw, cordless slide compound miter saw, cultivators, lawn mowers or some of the brush cutters / grass trimmers. In case of the brush cutters / grass trimmers, use the battery only with the tools with \square mark.
The mark is located at tool's battery insert port. (Fig. 2)

SAFETY INSTRUCTIONS FOR BATTERY

1. Before using battery, read all instructions and cautionary markings on battery and product using battery.
2. Do not disassemble battery.
3. If operating time has become excessively shorter, stop operating immediately. It may result in a risk of overheating, possible burns and even an explosion.
4. If electrolyte gets into your eyes, rinse them out with clear water and seek medical attention right away. It may result in loss of your eyesight.
5. Do not short the battery:
 - (1) Do not touch the terminals with any conductive material.
 - (2) Avoid storing battery in a container with other metal objects such as nails, coins, etc.
 - (3) Do not expose battery to water or rain.
A battery short can cause a large current flow, overheating, possible burns and even a breakdown.
6. Do not store the tool and battery in locations where the temperature may reach or exceed 50 °C (122°F).
7. Do not incinerate the battery even if it is severely damaged or is completely worn out. The battery cartridge can explode in a fire.
8. Be careful not to drop or strike battery.
9. Do not use dropped or struck battery.

Additional safety instructions:

1. Check all the screws on the battery's stopper heads are firmly tighten.
2. When switching on the battery, make sure tool's switch is off. Otherwise the tool may starts unintentionally and cause personal injury.
3. Check the battery is firmly set on the harness before use.
4. Do not use the battery at high places. Otherwise it may cause falling accidents.
5. Do not use the battery with a safety harness, as used for tree service. It may cause falling accidents.
6. Always pay attention for tool's rotating part. In case you use the tool of which rotating part is possibly be placed near your body, remove the harness and place the battery on the ground. Otherwise the harness may be entangled by the tool, and result in personal injury.
7. During operation, keep the cord away from obstacles such as branches. The cord caught by obstacles may cause serious injury.
8. Always be sure that the battery cartridges are removed before attempting to perform inspection or maintenance such as replacing a shear blade.

9. For storage, keep the battery in the carton box with the instruction manual.
10. The battery is classified as dangerous goods by UN Recommendations on the Transport of Dangerous Goods as well as the other regulations. The battery contains lithium ion battery. The lithium ion battery and the electrolyte used in the lithium ion battery are subject to those regulations.
11. When transporting the battery by surface or air, it is required to submit the application form for dangerous goods along with necessary packing for the battery by the owner. In case you transport the battery, you will bear responsibility for it as 'the owner'.
Complying with ICAO T1 and IATA DGR, the battery cannot be transported by passenger flights but only by freighters.

Tips for maintaining maximum battery life:

1. Never recharge a fully charged battery.
2. Overcharging shortens the battery service life.
3. Charge the battery with room temperature at 10 °C – 40° C (50° F – 104° F). Let a hot battery cartridge cool down before charging it.
4. Charge the battery once in every six months if you do not use it for a long period of time.

Note:

The recycling method may differ from country to country, or state (province) to state (province). Consult with your nearest Makita Authorized Service Center or Distributor.

SAFETY INSTRUCTIONS FOR BATTERY CHARGER

⚠ CAUTION:

- THIS APPLIANCE CAN BE USED BY CHILDREN AGED FROM 8 YEARS AND ABOVE AND PERSONS WITH REDUCED PHYSICAL, SENSORY OR MENTAL CAPABILITIES OR LACK OF EXPERIENCE AND KNOWLEDGE IF THEY HAVE BEEN GIVEN SUPERVISION OR INSTRUCTION CONCERNING USE OF THE APPLIANCE IN A SAFE WAY AND UNDERSTAND THE HAZARDS INVOLVED. CHILDREN SHALL NOT PLAY WITH THE APPLIANCE. CLEANING AND USER MAINTENANCE SHALL NOT BE MADE BY CHILDREN WITHOUT SUPERVISION.

• SAVE THESE INSTRUCTIONS

– This manual contains important safety and operating instructions for battery charger.

- **CAUTION** – To reduce risk of injury, charge only MAKITA rechargeable battery. Other types of batteries may burst causing personal injury and damage.

- Use the proper charger for the tool to be charged.
- Handle the charger carefully. If dropped or hit against something, the charger may be deformed, cracked or damaged.
- Never carry charger by cord or yank it to disconnect from receptacle.
- Keep cord away from heat, oil, chemicals, and sharp edges.
- Use a power source with the voltage specified on the nameplate of the charger.
- Do not attempt to use a step-up transformer, and engine generator or DC power receptacle.
- Do not expose charger to rain or snow.
- Charge away from volatile, flammable material such as gasoline, paint, gas, adhesive, etc.
- Do not disassemble the charger.
- The battery charger is intended for charging MAKITA internal battery type products only.
- Do not operate the tool during charging.
- Always unplug the supply before making or breaking connections to the battery.
- Do not attempt to recharge non-rechargeable batteries.

PARTS DESCRIPTION

(Fig. 1)

- | | | |
|----------------------|-----------------|------------------|
| 1. Adapter | 4. Pocket | 7. Shoulder belt |
| 2. Battery charger | 5. Harness | 8. Lower buckle |
| 3. Battery indicator | 6. Upper buckle | 9. ON/OFF switch |

FUNCTIONAL DESCRIPTION

Switch action (Fig. 3)

To switch on the battery, press the ON/OFF switch button (9). To switch off the battery, press the switch button again.

Battery protection system

The battery is equipped with a protection system. This system automatically cuts off power to the tool to extend battery life. The tool automatically stops during operation when the battery is placed under one of the following conditions:

- **Overloaded:**
The tool is operated in a manner that causes it to draw an abnormally high current. In this situation, turn the tool off, remove the adapter from the tool, and then stop the application that caused the tool to become overloaded.
- **Overheated:**
Then attach the adapter and turn the tool on to restart. When the battery is overheated, the power is cut off automatically. The tool does not operate even it is switched on. In this situation, stop using the battery, remove the adapter from the tool, and then cool down the battery.
- **Low battery voltage:**
The remaining battery capacity is too low and the tool does not operate. In this situation, remove the adapter from the tool and recharge the battery. The charging does not start when battery protection system works because the battery is too hot or cold. The charging resumes when the battery's temperature returns to normal.

Checking the remaining battery capacity (Fig. 4)

Press the check button (10) to indicate the remaining battery capacity.

The indicator lamp (11) then lights up for approx. three seconds.

Lamp indications

Indicator lamps		Remaining charge	
■: On	□: Off		
Empty	■ ■ ■ ■	Full	70% to 100%
	■ ■ ■ □		45% to 70%
	■ ■ □ □		20% to 45%
	■ □ □ □		0% to 20%
	■ □ □ □		Charge the battery.
	□ □ ■ □		The battery protection system is working.
	□ □ □ ■		
	■ □ □ □		* See below.

- * This indication is a temporary error or malfunction of the battery. In this case, 1. switch off the battery and turn it on again then check if the tool works; 2. if the lamps still light alternately, switch off the battery and switch the adapter position (when using double type adapter only); 3. if the lamps still light alternately, contact your local Makita service center to request inspection and/or repair.

Note:

- When only the lowermost indicator lamp blinks, or when none of the indicator lamps light, the battery capacity has run out and the tool does not operate. In these cases, charge the battery.
- When two or more indicator lamps do not light even after charging is complete, the battery has reached the end of its service life.
- The indicated capacity may be lower than the actual level during use or immediately after using the tool.
- Depending on the conditions of use and the ambient temperature, the remaining battery capacity may not be displayed correctly.

ASSEMBLY

Installing or removing the battery to the harness

Place the battery on a flat surface when installing or removing the battery.

To install the battery (Fig. 5)

Align the holes of the harness with the holes of the battery. And then tighten them with six bolts.

CAUTION:

- Make sure that the battery sits on the harness stably after installation.

To remove the battery

Remove six bolts and then remove the battery.

Adjusting the harness (Fig. 6, 7 & 8)

Make sure that the harness is stably installed on the battery before adjusting the harness.

Adjust the harness as follows:

1. Adjust the shoulder belt (7). To fasten the strap, pull the end of the strap downwards. To loosen the strap, pull up the end of the fastener (12).
2. Adjust the position of the upper buckle (6). Close and lock the upper buckle and adjust its belt length.
3. Close and lock the lower buckle (8), and adjust its belt length.

CAUTION:

- After adjusting the belt length, run the belt through the band "A" to avoid a belt becoming loose.

OPERATION

Connecting to the adapter (Fig. 9, 10 & 11)

Connect the socket (13) of the battery to the plug of the adapter (1).

To connect the sockets, align the connection terminals and press them in, and then turn the socket to fasten them.

Then connect the adapter to the tools.

The pocket (4) is useful for keeping the adapter temporarily.

Note:

- Do not attach the adapters with the cable to the battery passed over/under the cable connecting the two adapters (Fig. 10). Incorrect attachment results in stoppage of the tool.
- If one end of the adapter (21) does not fit on one of the port of the tool, put another end of it.

Charging the battery (Fig. 12)

Remove the cap (14), and then connect the charging plug to the charging socket, then plug in the charger to the power receptacle.

The indicator lamp lights during the charging. The light goes off when the charging is completed.

When charging is completed, remove the battery and return the cap.

The following table indicates the types of battery, the number of cells and the rated capacity which can be charged by the battery charger.

Battery charger	Battery type	Voltage (V)	Number of cells	Capacity (mAh)	Charging time (hours)
DC3600	Li-ion	36	60	12,000	(Approx.) 3

Installing the shoulder harness (optional accessory) for brush cutters / grass trimmers (Fig. 13, 14 & 15)

1. Attach the hooks A (15) of the shoulder harness onto the D rings (16) of the battery's harness respectively.
2. Hang the brush cutters / grass trimmers by the hook B (17). To release the machine, push the notches (18) at both sides.

Emergency detachment (Fig. 16 & 17)

1. Push the notches (19) at both sides to release the upper buckle and lower buckle.
2. Take off the shoulder bands (20), and detach the battery and the machine.

MAINTENANCE

To maintain product SAFETY and RELIABILITY, repairs, maintenance or adjustment should be performed by Makita Authorized or Factory Service Centers, always using Makita replacement parts.

Never use gasoline, benzene, thinner, alcohol or the like when cleaning the battery. Discoloration, deformation or cracks may result.

- Due to our continuing program of research and development, the specifications herein are subject to change without notice.

OPTIONAL ACCESSORIES

CAUTION:

- These accessories or attachments are recommended for use with your Makita tool specified in this manual. The use of any other accessories or attachments might present a risk of injury to persons. Only use accessory or attachment for its stated purpose.

If you need any assistance for more details regarding these accessories, ask your local Makita Service Center.

- Adapter (21) (Fig. 18)

Note:

- Some items in the list may be included in the tool package as standard accessories. They may differ from country to country.

Makita Europe N.V. Jan-Baptist Vinkstraat 2,
3070 Kortenberg, Belgium

Makita Corporation 3-11-8, Sumiyoshi-cho,
Anjo, Aichi 446-8502 Japan

BL36120A-29L-0116

www.makita.com

IDE