

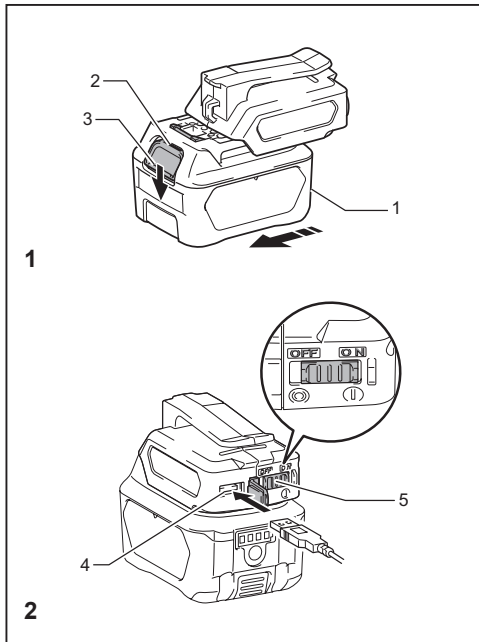

# ADP06



## ENGLISH (Original instructions)

## SPECIFICATIONS

Model		ADP06
USB power supply	Ports	1 (USB A type)
	Output voltage	D.C. 5V
	Output current	2.1A
	Input rating	D.C. 10.8V - 12V max
Max. operating temperature		40 degree C
Battery cartridge	Size (L x W x H)	Weight
Without battery	80 mm x 53 mm x 38 mm	0.07 kg
BL1015/BL1016/ BL1020B/BL1021B	88 mm x 64 mm x 63 mm	0.28 kg

BL1040B/BL1041B	88 mm x 64 mm x 82 mm	0.44 kg
-----------------	-----------------------	---------

- Due to our continuing program of research and development, the specifications herein are subject to change without notice.
- Specifications may differ from country to country.

## SYMBOLS

- ..... Read instructions.
- ..... Only for EU countries  
Do not dispose of electric equipment or battery pack together with household waste material!  
In observance of the European Directives, on Waste Electric and Electronic Equipment and Batteries and Accumulators and Waste Batteries and Accumulators and their implementation in accordance with national laws, electric equipment and batteries and battery pack(s) that have reached the end of their life must be collected separately and returned to an environmentally compatible recycling facility.

## SAFETY INSTRUCTIONS

### Important safety instructions for battery cartridge

- Recharge only with the charger specified by the manufacturer. A charger that is suitable for one type of battery pack may create a risk of fire when used with another battery pack.
- Use the product only with specifically designated battery packs. Use of any other battery packs may create a risk of injury and fire.
- Before using battery cartridge, read all instructions and cautionary markings on battery charger, battery, and product using battery.
- Do not disassemble battery cartridge.
- If operating time has become excessively shorter, stop operating immediately. It may result in a risk of overheating, possible burns and even an explosion.
- Under abusive conditions, liquid may be ejected from the battery; avoid contact. If electrolyte gets into your eyes, rinse them out with clear water and seek medical attention right away. It may result in loss of your eyesight.

- Do not short the battery cartridge:
  1. Do not touch the terminals with any conductive material.
  2. Avoid storing battery cartridge in a container with other metal objects such as nails, coins, etc.
  3. Do not expose battery cartridge to water or rain.

A battery short can cause a large current flow, overheating, possible burns and even a breakdown.

- Do not store the product and battery cartridge in locations where the temperature may reach or exceed 50°C (122°F).
- Do not incinerate the battery cartridge even if it is severely damaged or is completely worn out. The battery cartridge can explode in a fire.
- Be careful not to drop or strike battery.
- Do not use a damaged battery.
- Follow your local regulations relating to disposal of battery.
- To avoid risk, the manual of replaceable the battery should be read before use. And the max discharging current of the battery should be greater than or equal to 8A.

### CAUTION:

- Danger of explosion if battery is incorrectly replaced.
- Replace only with the same or equivalent type.

### Tips for maintaining maximum battery life

- Never recharge a fully charged battery cartridge. Overcharging shortens the battery service life.
- Charge the battery cartridge with room temperature at 10°C - 40°C (50°F - 104°F).
- Let a hot battery cartridge cool down before charging it.
- For an optimum life-time, the battery cartridge has to be fully charged, after use.

### SAVE THESE INSTRUCTIONS.

## INSTALLING OR REMOVING BATTERY CARTRIDGE (Fig. 1)

To install the battery cartridge (1), align the tongue on the battery cartridge with the groove in the product and slip it into place. Insert it all the way until it locks in place with a little click. If you can see the red indicator (2) on the upper side of the button, it is not locked completely. Always install the battery cartridge fully until the red indicator cannot be seen. If not, it

may accidentally fall out of the battery holder, causing injury to you or someone around you. Do not install the battery cartridge forcibly. If the cartridge does not slide in easily, it is not being inserted correctly.

To remove the battery cartridge, slide it from the product while sliding the button (3) on the front of the cartridge.

## CONNECTING USB DEVICE (Fig. 2)

### CAUTION:

- Connect only devices which are compatible with DC5V, 2.1A power source to the USB power supply port. Otherwise it may cause malfunction to the product.

Connect the USB cable (not included) with the power supply port (4) of the product. And then connect the other end of the cable with the device.

To start charging, move the slide switch (5) to "ON" side. To stop charging, move the slide switch to "OFF" side.

You can also hang the product on your belt.

### NOTE:

- Before connecting USB device to the product, always backup your data of USB device. Otherwise your data may lose by any possibility.
- The product may not supply power to some USB devices.
- Do not insert a nail, wire, etc. into USB power supply port. Otherwise a circuit short may cause smoke and fire.
- When not using, move the slide switch to "OFF" side. Otherwise the battery capacity may be reduced during course of time.
- When not using or after charging, remove the USB cable and close the cover.
- After charging or during storage, remove the battery cartridge from the adapter.

Makita Europe N.V.

Makita Corporation

3-11-8, Sumiyoshi-cho,

www.makita.com